

**APPLICATION - APPROVAL TO USE
FOOTPATH AND/OR PUBLIC PLACE**



Footpath Dining/Sign

PO Box 81
DUBBO 2830

Phone: 6801 4000
Fax: 6801 4259

E-mail: council@dubbo.nsw.gov.au

1. Applicant Details:

Title: Mr Mrs Miss Ms Other
Surname: _____
Given name/s: _____
Company/business name: _____
Postal address: _____
Business phone: _____ Fax: _____
E-mail: _____

2. Site Location:

Property address: _____
Lot and DP: _____
Nearest cross street: _____
Business/building name: _____

Is there a Development/Complying Development Application associated with this Application?

No Yes Application Number: _____

3. Activity Type Sought:

- Footpath dining
- Portable sign display
- Merchandise display
- Itinerant vendor/roadside trading

4. Details of Proposed Activity:

5. Proposed Period of Operation:

Operating hours - Monday to Friday	Open _____	Close _____
Operating hours - Saturday and Sunday	Open _____	Close _____
Operating hours - public holidays	Open _____	Close _____

Start date _____ End date _____

Notes:

- Approvals are granted for a maximum period of two (2) years.
- Should this application relate to a property in Macquarie Street Dubbo, please refer to page 3 of this application form and also to Council's 'Macquarie Street Dubbo – Outdoor Dining Policy' on Council's website: www.dubbo.nsw.gov.au/public-notice/notice-of-adoption-outdoor-dining-policy

6. Proposed Activity Layout:

For footpath dining or merchandise and sign display applications only please draw, or attach a separate plan, of the activity noting the following requirements:

1. A minimum 3 metres of clearway on the footpath for pedestrian traffic;
2. Merchandise display to be restricted to a maximum of 750 mm out from the front of the premises and not extending beyond the side boundaries;
3. Table and chair settings (to be drawn to scale);
4. All items such as barricading, waste bins, portable shade structures, to be noted; and
5. Attach pictures of the type of table and chair settings, umbrellas, barricades, etc intended to be used which demonstrate a 'smart, contemporary' style of furniture.

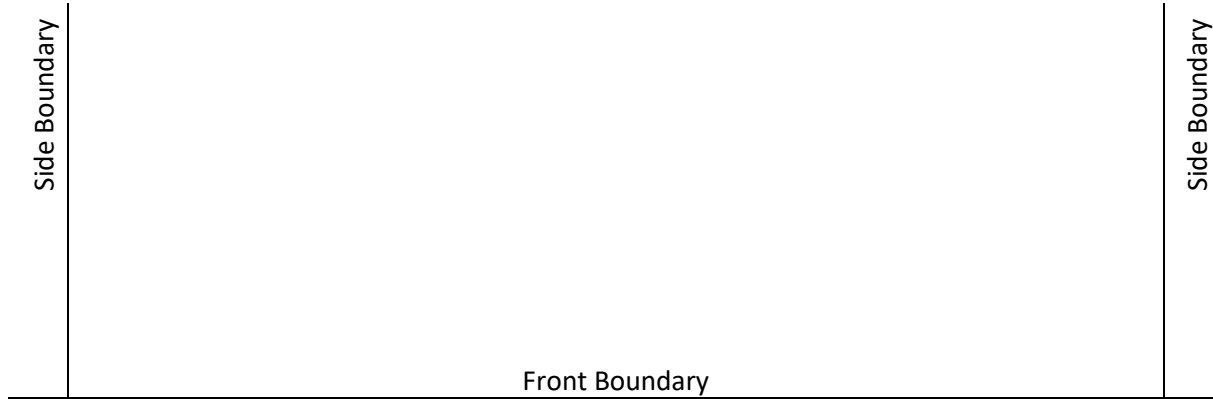

Kerb line: _____

Road centre line: _____

Applicant's Declaration:

1. I apply for approval in respect of the works described in this application, and declare to the best of my knowledge and belief, that the information supplied is correct and complete. I also understand that personal information provided on, or with this application, will be available to be accessed by the public pursuant to the Government Information (Public Access) Act. The subject Act permits members of the public to obtain extracts of the application's determination and certain accompanying documentation.
2. This application authorises Council officers to enter the property, perform any inspections associated with processing of the determination and compliance.
3. I am liable to pay for and/or rectify any damages caused to Council's roads, drains etc arising from the proposed activity.
4. The applicant holding a current Public Liability Insurance Policy for a minimum amount of \$20 million on which Dubbo Regional Council is specifically noted to be indemnified against any action resulting from the proposed works.

Checklist: A Plan of the proposed activity is required to be sketched in Section 6, or attach a copy of the site plan, layout drawings etc.

NOTE: The application fee is to be paid at the time of lodgement of this application. Any applicable rental fee/s will be notified in the approval letter and is required to be paid prior to commencement of work onsite.

Applicant's Signature: _____ Date: _____

OFFICE USE:

Application number: _____

Amount paid: N/A FY 2020/2021 Receipt number: _____

Payment date: _____ Processed by: _____

Category A: Permanent outdoor dining locations - these locations have been identified as larger areas capable of facilitating permanent outdoor dining structures (pergolas, etc).

Category B: Temporary outdoor dining locations - these locations provide temporary outdoor dining opportunities as previously facilitated by Council's Street Trading Policy.

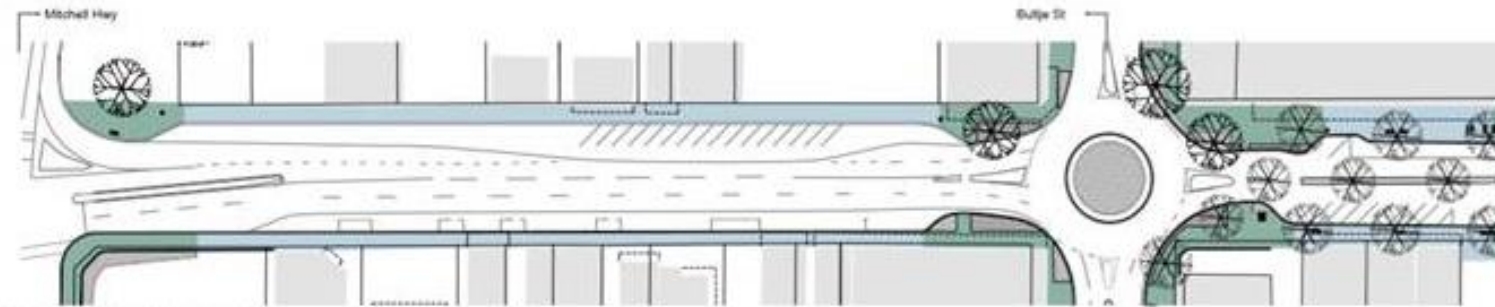

Appendix N: Macquarie Street Section A

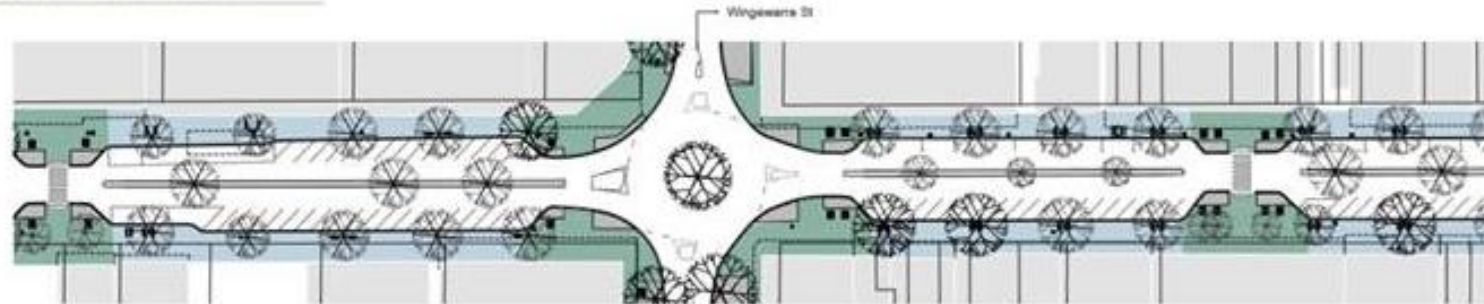

Appendix O: Macquarie Street Section B

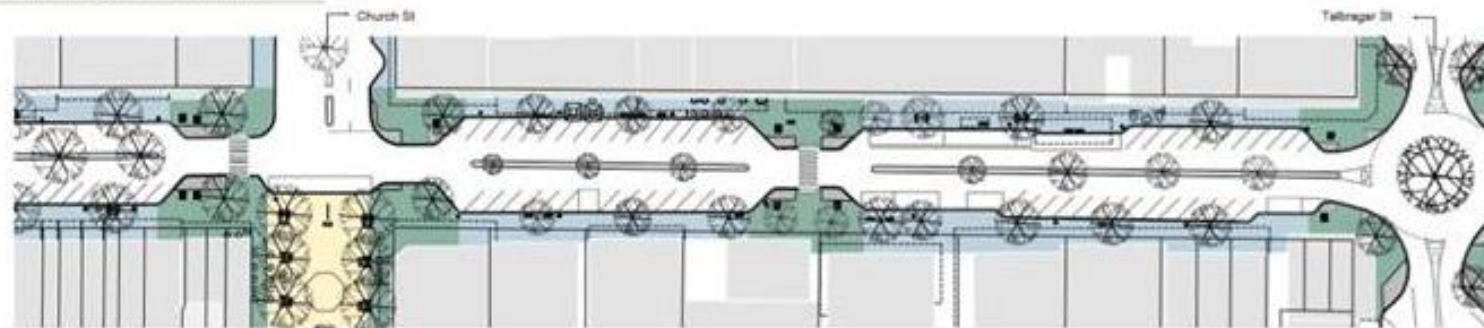

Appendix P: Macquarie Street Section C

